

# SERIES 'PL' / 'CL' PLASTIC DISC FILTER CHAMBERS

## PVC or CPVC CHAMBERS FOR:

### ACID / AQUEOUS / CHEMICAL ELECTROPLATING / WASTE TREATMENT



- **Non-metallic solution contact**  
PVC or CPVC with Viton®, EPDM, or Hypalon® elastomers (See a chemical resistance chart)
- **Heavy duty construction** – machined base, rugged polypropylene plates
- **High flow rate, low pressure drop**  
2" connections
- **High capacity** —  
15, 30, 45 ft<sup>2</sup> (1.4, 2.8, 4.2 m<sup>2</sup>) solids area
- **Stack assembly for quick media change**
- **Choice of filter media:**  
**Cellulose discs for 5, 10, 20 & 40 micron filtration**  
Use alone or with filter aid and/or powdered carbon  
**Carbon discs for purification**  
Interchangeable with filter discs

These disc filter chambers are designed for quality filtration of plating and other chemical solutions. The large surface area with I.D. and O.D. edge seals on all filter discs assures optimum performance and clarity of solution being filtered. Disc filters may be used with a precoat of filter aid alone or with a mixture of filter aid and powdered carbon. Carbon discs are also available and may be installed in total or in partial to accomplish the proper degree

of organic removal. Some applications may allow filtration without a media precoat. Chambers include a drip pan to catch run-off liquid when servicing discs.

Disc chambers are serviced by lifting the cover and disc stack assembly from the chamber, facilitating a cleaner change-out and less solution loss than with other designs. No messy "floating" of the disc is required when changing the disc media.

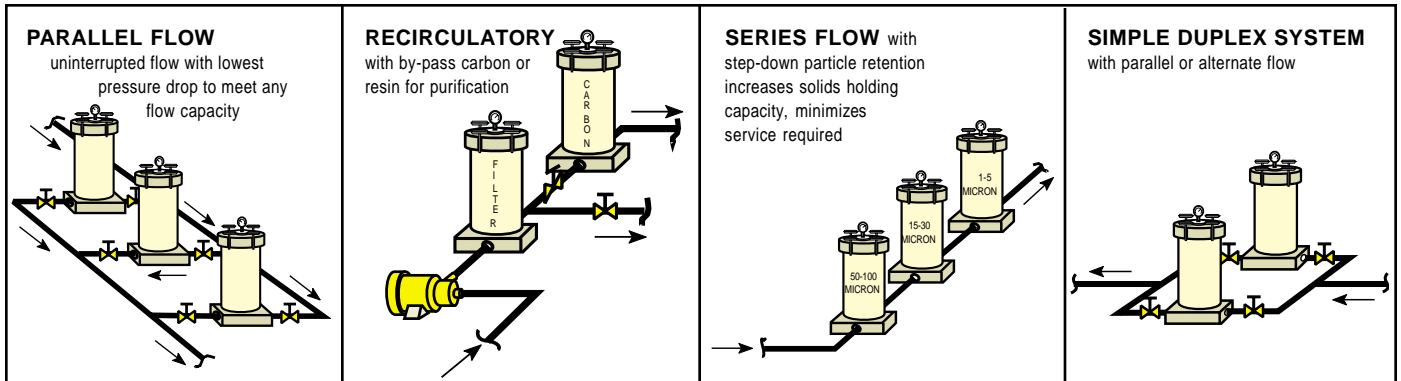

**'PL' and 'CL' FILTER CHAMBERS (cont'd)**

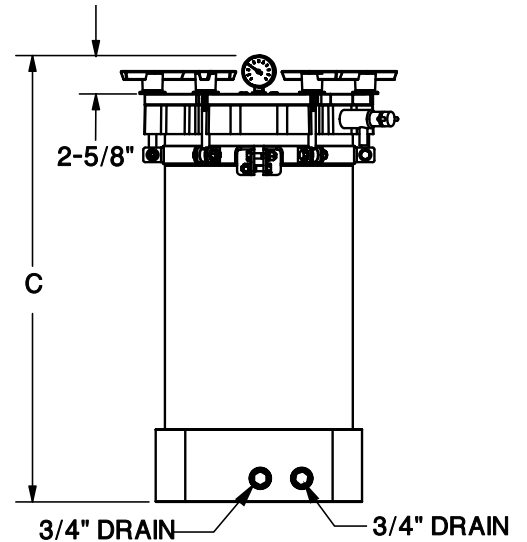
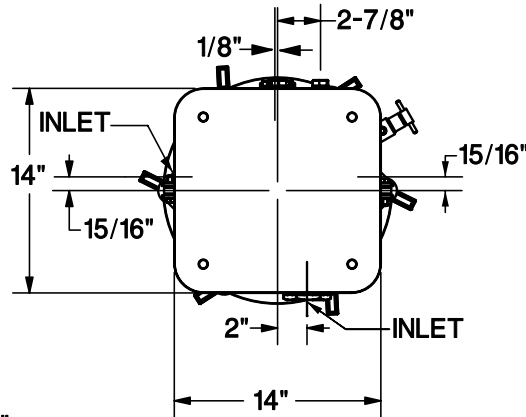
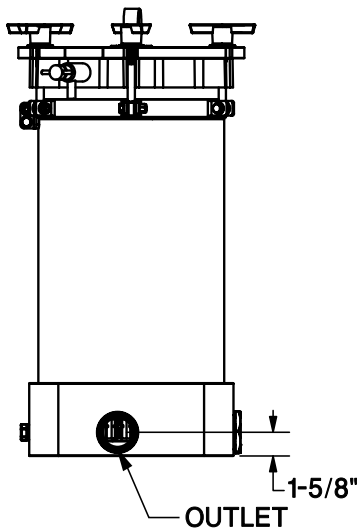

FLOW RATE vs. PRESSURE DIFFERENTIAL
115 GPM @ 5 PSI
145 GPM @ 15 PSI

MAXIMUM PSI		@ OPERATING TEMP.
PVC	CPVC	
80	80	70°F
75	75	100°F
40	70	120°F
25	55	140°F
—	35	170°F
—	30	200°F

NO. OF DISCS	SOLIDS AREA sq. ft.	DIM. 'C'
31	15	20-15/16
65	30	30-15/16
99	45	40-15/16

TO ORDER, use Price Code Number								
MATERIALS	NO. OF DISCS	AREA		MODEL NUMBER	MAX FLOW		PRICE CODE NUMBER	SHIP. WT. (lbs.)
		ft <sup>2</sup>	m <sup>2</sup>		GPH	LPH		
PVC/EPDM	31	15	1.4	PL15DFC-2-G3A	3000	11,355	78-1685 P	77
	65	30	2.8	PL30DFC-2-G3A	4500	17,033	78-1686 P	92
	99	45	4.1	PL45DFC-2-G3A	6000	22,710	78-1687 P	107
CPVC/EPDM	31	15	1.4	CL15DFC-2-G3A	3000	11,355	78-1685 C	77
	65	30	2.8	CL30DFC-2-G3A	4500	17,033	78-1686 C	92
	99	45	4.1	CL45DFC-2-G3A	6000	22,710	78-1687 C	107

For Viton elastomers:  
add -V to Price Code Number and change L to V in Model Number

FILTER DISCS FOR MODEL 'PL' OR 'CL' CHAMBERS (ordered separately) packaged in quantities of 100			
DISC MODEL NUMBER	MICRON RATING	PRICE CODE NUMBER	
		1 to 4 CARTONS	5 to 9 CARTONS
CE 5 x 10	5	78-1612	78-1612A
CE 10 x 10	10	78-1613	78-1613A
CE 20 x 10	20	78-1614	78-1614A
CE 40 x 10	40	78-1615	78-1615A
C x 10 CARBON	10	78-1616	78-1616A